

## Dial Calipers Series 505



505-675



505-717

### Features

- Improved durability, the sliding surfaces of the main blade are coated with titanium.
- Slider displacements are amplified by a rack-and-pinion mechanism indicated on the dial.
- QUADRI (4-Way) measurement, see next page.
- Extra-rigid main beam. Hardened stainless steel.
- Supplied in fitted carrying case.

### • Black-Face/Ratchet Type

Model **505-675-66** features an alternative dial face in black with white markings and a bright orange indicator needle for easy reading. This model is also equipped with Mitutoyo's new ratchet thumb roller providing a positive-clicking action just like a micrometer ratchet thimble.

- Other alternate color dial face calipers are also available which are useful for identifying different users or departments and maintaining calibration schedules. See listing below.

### Specifications

#### Dial Calipers

#### Inch

Order No.	Range	Dial Reading Resolution	Dial Reading Range/Rev.	Accuracy (20*)	Remarks
505-716	0–4"	.001"	.20"	±.001"	Dial Face: A
505-674	0–4"	.001"	.10"	±.001"	Dial Face: B
505-717	0–6"	.001"	.20"	±.001"	Dial Face: A
505-675	0–6"	.001"	.10"	±.001"	Dial Face: B
505-675-51	0–6"	.001"	.10"	±.001"	Blue Dial Face, Dial Face: B
505-675-52	0–6"	.001"	.10"	±.001"	Purple Dial Face, Dial Face: B
505-675-53	0–6"	.001"	.10"	±.001"	Green Dial Face, Dial Face: B
505-675-54	0–6"	.001"	.10"	±.001"	Red Dial Face, Dial Face: B
505-675-55	0–6"	.001"	.10"	±.001"	Orange Dial Face, Dial Face: B
505-675-56	0–6"	.001"	.10"	±.001"	Black Dial Face, Dial Face: B
505-675-66	0–6"	.001"	.10"	±.001"	Black Dial Face, Dial Face: B with Ratchet Stop
505-718	0–6"	.001"	.20"	±.001"	Dial Face: A with OD Carbide Jaw
505-708	0–6"	.001"	.10"	±.001"	Dial Face: B with OD Carbide Jaw
505-712	0–6"	.001"	.10"	±.001"	Dial Face: B with OD, ID Carbide Jaw
505-689	0–6"	.001"	.10"	±.001"	Dial Face: B Extra Smooth Movement
505-690	0–8"	.001"	.10"	±.002"	Dial Face: B Extra Smooth Movement
505-719	0–8"	.001"	.20"	±.002"	Dial Face: A
505-676	0–8"	.001"	.10"	±.002"	Dial Face: B
505-709	0–8"	.001"	.10"	±.002"	Dial Face: B with OD Carbide Jaw
505-713	0–8"	.001"	.10"	±.002"	Dial Face: B with OD, ID Carbide Jaw
505-720	0–12"	.001"	.20"	±.002"	Dial Face: A
505-721	0–12"	.001"	.20"	±.002"	Dial Face: A with OD Carbide Jaw
505-677	0–12"	.001"	.10"	±.002"	Dial Face: B
505-710	0–12"	.001"	.10"	±.002"	Dial Face: B with OD Carbide Jaw
505-714	0–12"	.001"	.10"	±.002"	Dial Face: B with OD, ID Carbide Jaw

# CALIPERS

## “Quadri” (4-way) Measurement

1. Outside measurement

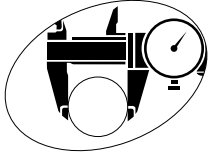

2. Inside measurement

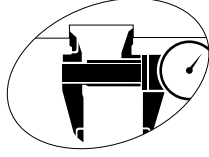

3. Step measurement

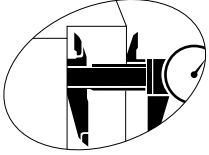

4. Depth measurement

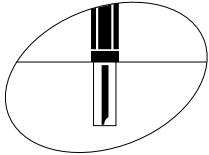

## Dimensions

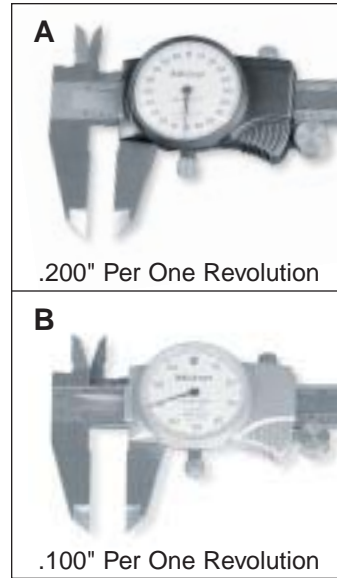
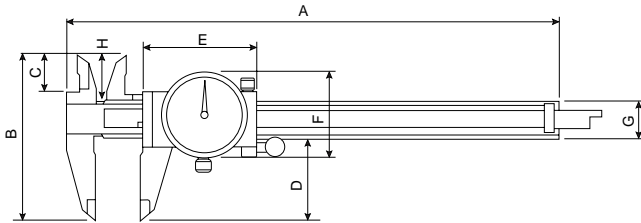

## Dimensions

Order No.	A	B	C	D	H	E	F	G	t <sup>※</sup>
505-674	7.1"								
505-716									
505-675	9.1"	3.03"	.65"	1.57"	.83"	2.25"	1.5"	.63"	.35"
505-675-51									
505-675-52									
505-675-53									
505-675-54									
505-675-55									
505-675-56									
505-675-66									
505-689									
505-708									
505-712	11.34"	3.56"	.79"	1.97"	.96"				
505-717									
505-718									
505-676									
505-690									
505-709	15.9"	4.4"	.87"	2.52"	1.08"	2.7"	1.7"	.79"	.15"
505-713									
505-719									
505-677									
505-710									

※ t : Jaw Thickness

## Dial Calipers Series 505



505-671

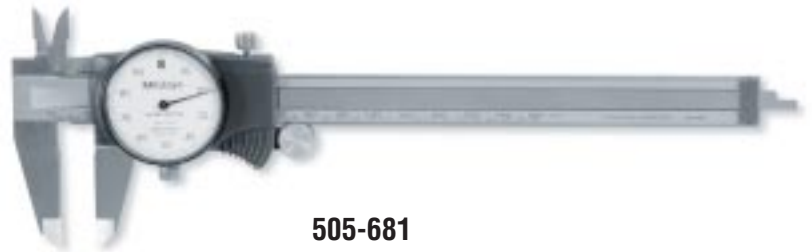

505-681

### Features

- Improved durability, the sliding surfaces of the main blade are coated with titanium.
- Shock proof construction 1mm revolution models.
- Supplied in fitted carrying case.

### Specifications

#### 1mm / Revolution

##### Metric

Order No.	Range	Dial Reading		Accuracy	Remarks
		Resolution	Range/Rev.		
505-680	0–100mm	0.01mm	1.0mm	±0.015mm	Dial Face: C
505-681	0–150mm	0.01mm	1.0mm	±0.02mm	Dial Face: C
505-682	0–150mm	0.01mm	1.0mm	±0.03mm	Dial Face: C

#### 2mm / Revolution

##### Metric

Order No.	Range	Dial Reading		Accuracy	Remarks
		Resolution	Range/Rev.		
505-671	0–150mm	0.02mm	2.0mm	±0.03mm	Dial Face: D
505-707	0–150mm	0.02mm	2.0mm	±0.03mm	Dial Face: D with OD carbide jaw
505-711	0–150mm	0.02mm	2.0mm	±0.03mm	Dial Face: D with OD, ID carbide jaw
505-683	0–150mm	0.02mm	2.0mm	±0.03mm	Dial Face: D with extra smooth movement
505-672	0–200mm	0.02mm	2.0mm	±0.03mm	Dial Face: D
505-684	0–200mm	0.02mm	2.0mm	±0.03mm	Dial Face: D with extra smooth movement
505-673	0–300mm	0.02mm	2.0mm	±0.04mm	Dial Face: D

# CALIPERS

## “Quadri” (4-way) Measurement

1. Outside measurement

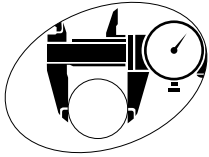

2. Inside measurement

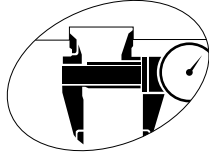

3. Step measurement

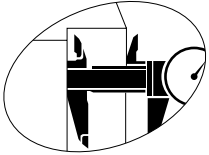

4. Depth measurement

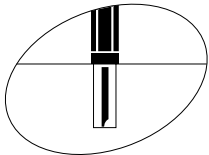

## Dimensions

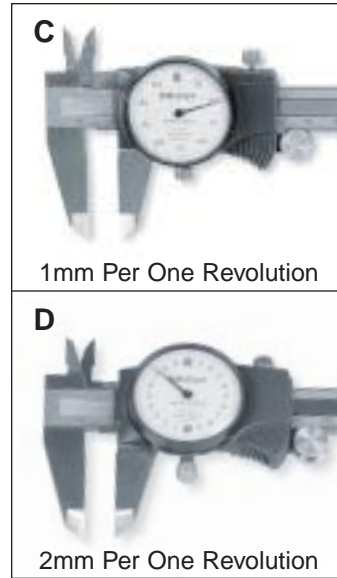
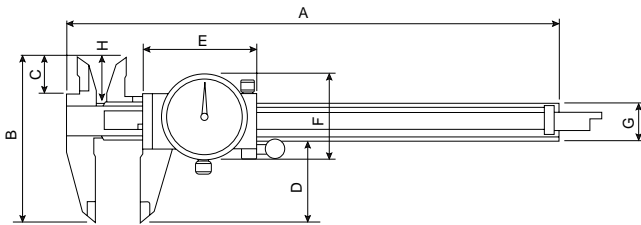

## Dimensions

unit:mm

Order No.	A	B	C	D	H	E	F	G	t <sup>※</sup>
505-680	180								
505-671									
505-681									
505-683	231	77	16.5	40	21	57.2	39.5	16	3.5
505-707									
505-711									
505-672									
505-682	288	90.5	20	50	24.5				
505-648									
505-714	403	111.5	22	64	27.5	70.2	43.4	20	3.8

※ t : Jaw Thickness